

## SDB Tank Bottom Mixer



### Application

Tank bottom mixer series of the high shear bottom of the tank mixers present a highly hygienic solution for the processes of dispersion, emulsifying, homogenisation and disintegration of solids in the food-processing, cosmetics, pharmaceutical and fine chemistry industries.

These mixers can be used either in open or closed tanks at atmospheric pressure or under pressure/vacuum.

The bottom of the tank mixers are designed for the applications of the highly viscous media and intended for work with anchor type agitators.

### Operation

High-speed rotation of the rotor blades pulls liquid and solid materials down to the center of the working head, providing a powerful suction.

The high speed and adjusted tolerances between the rotor and the stator result in high suction potential, the product is suctioned and driven to the centre of the head.

The product is suctioned from the upper part of the head and the rotor thrusts it radially.

Passing through the opening of the stator the product is mechanically sheared, the particles are sheared by the rotor at 20 m/s.

Finally this flow is hydraulically sheared leaving the stator through the slots at a high speed.

### User Benefits

Fast, effective liquid mixing performance in tanks

Efficient gas and powder dispersion

Can be used as tank cleaning machine

Handles multiple applications

Unmatched, cost-effective mixing performance

Simplified, hygienic design, modest investment

## OPTIONS

Flushed mechanical seal.  
 Pressurised mechanical seal by means of a lip seal or double mechanical seal.  
 Disintegrating head. Fine screen head.  
 Bare shaft construction for big size models, transmission by pulleys and belts.  
 Assembly of cutters and propeller on the upper part of the rotor.  
 Surface finish:  $Ra \leq 0,5 \mu\text{m}$  for the pharmaceutical applications.  
 Other motor protections.

## Configuration

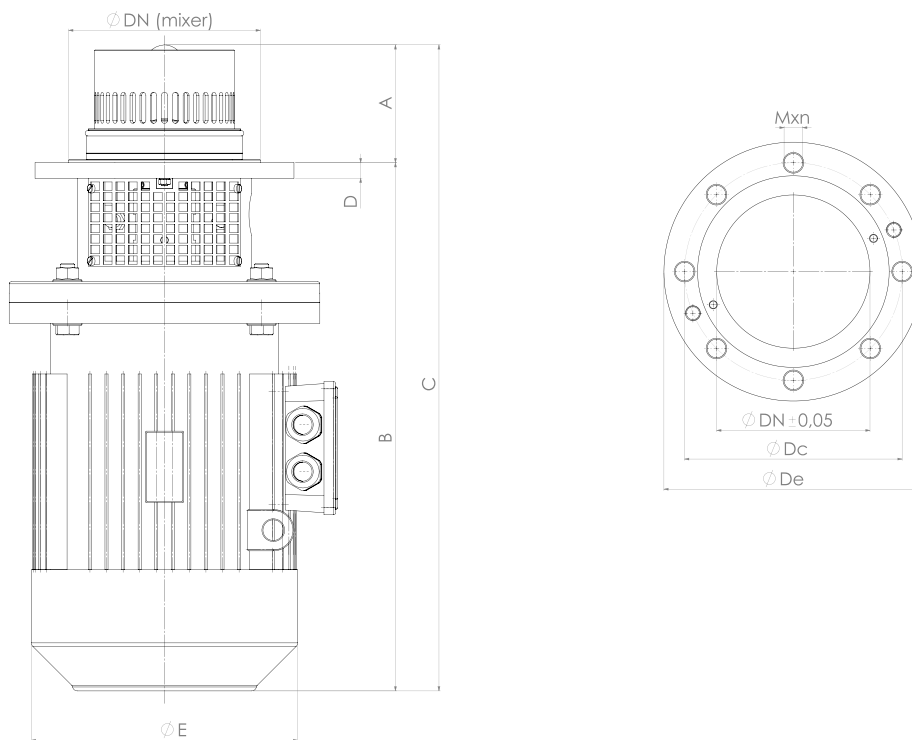

## Dimensions

TYPE	$\varnothing Dn$	$\varnothing De$	$\varnothing Dc$	m*n	A	B	C	D	Q	R
SDB-30-022	200	160	131,5	M 16*4	82	355	437	18	180	122
SDB-30-040	250	210	150	M 16*8	87	436	523	15	236	148
SDB-30-075	250	210	150	M 16*8	87	492	579	15	261	163
SDB-30-185	330	300	175	M 16*8	108	656	764	26	310	208
SDB-15-220	330	300	175	M 16*8	144	730	838	26	349	223

## Capacity

TYPE	3000 cpu	Additional agitation 3000 cpu	Power(kw)	Speed(rpm)
SDB-30-022	100 L	300 L	2,2	3000
SDB-30-040	300 L	750 L	4	3000
SDB-30-075	750 L	1500 L	7,5	3000
SDB-30-185	1000 L	2000 L	18,5	3000
SDB-15-220	1500 L	2500 L	22	1500